

VIETA PRO

Bluetooth Headset Unseen

Ref. VHP-TW20BK

 English



LetMeRepair
Spain

Dear customer,
Thank you for purchasing the VHP-TW20BK Bluetooth headset.
To ensure proper operation, read this user's manual
carefully before operation.

Have a problem with your product?
Contact us at:
Email: vieta@letmerepair.es
Phone: 952 179 479

User Manual

**VIETA
PRO**

Bluetooth headset should be used with the compatible devices which support Bluetooth wireless technology. This allows you make two calls and enjoy the music streaming at any time freely.

Please read this user manual carefully before using the headset, and also read your device's user manual regarding the Bluetooth function, and pay attention to those important safety and maintenance information.

Please keep the headset away from children.

Headset specifications

- Bluetooth Version: 5.0.
- Support: HSP, HFP, A2DP, AVRCP.
- Audio Decoding Protocol: SBC, AAC.
- Transmission Power: Class 2
- Operation Range: Up to 10 meters
- Frequency Range: 2.4GHz-2.48GHz
- Battery of Headset: 45mAH
Li-polymer Battery
- Charging Voltage of Headset: DC $5 \pm 0.25V$
- Charging Time of Headset: About 1.5 hours
- Music Playing Time: $6H \pm 0.5H$.
- Talk time: $6H \pm 0.5H$.
- Standby Time: About 85 hours.
- Driver: $\phi 6mm$.
- Driver sensitivity: $93 dB \pm 3dB$.
- Driver impedance: $16 \Omega \pm 15\%$.
- Driver frequency ring range: 20Hz-20kHz.
- Dimensions of single headset(mm): $L27 \times W22.8 \times H26$
- Weight of single headset(mm): About 5.0g

Charging base specifications

- Charging base battery specifications: 460mAH Li-polymer Battery
- Charging base voltage: DC 4.7V-6V.
- Charging time of base: About 2 hours
- Charging Headset Times from Charging base: 3 times.
- Charging base size (mm): $L80 \times W33 \times H31$
- Weight(Total): About 58g

*The time mentioned above may vary due to user's operation mode and device settings.

Structure Sketch

1. MFB(multifunction button)



3. Speaker

2. Indicator Light (MIC)



4. The charging contact point



5. ON/OFF for
the base

6. Charging base indicator



7. Micro USB charging port

Headset status

Status No.	Status	Headset Performance
1	The headset(R) Single Pairing	The indicator light of headset(R) flashes red and blue alternately
2	TWS Pairing	The indicator light flashes blue and red once every 15 seconds.
3	Standby Mode	The indicator light of the headset flashes blue once every 5 seconds
4	Call Mode	When in a call, the indicator light of the headset flashes red every 5 seconds
5	Headset Charging Mode	The indicator light of the headset is red when being charged, and will turn off automatically after being fully charged

Headset status

Status No.	Status	Headset Performance
6	Charging Base Charging Mode	The indicator blue lights of the charging base flashes when being charged, and four blue lights are on after being fully charged
7	Power On State	After power on the indicator light flashes blue for 3 times.
8	Power Off State	When power off the indicator light flashes red for 3 times.
9	Low Voltage Alarm State	The indicator light flashes red once every 20 seconds

Headphone identification



Headset (L)



Headset (R)

Wearing Steps:

Step 1

Erect headset and place them into the cochlea

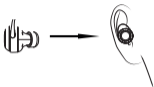

Step 2

Slightly rotate headset until it firm

Step 3:

Make the headset to cochlear edge tightly.



Charging Ways of Headset



The indicator light of headset is red when being charged, and will turn off automatically after being fully charged.

Put the headset (L) (R) to the corresponding position in the bottom of the charging base, and press the charging base switch.

Charging Ways of Charging Base



- Use the USB charging cable



- Use the USB cable to connect with computer
- Use the USB cable to connect with mobile phone charger

Note 1: Check the charging device suits to the headset or not.

Note 2: Use only the supplied charger to charge the headset, if using other device it may violate or the maintenance article of this product and may cause danger.

Note 3: Do not attempt to force open the built-in battery as this could damage the headset.

Note 4: A fully charged headset will lose its power automatically if left unused. It is recommended to charge the headset each three months.

Note 5: Do not leave the headset in a too hot or too cold condition (best between -10°C and 50°C) which may affect the headset's operations although it is fully charged.

Note 6: Do not dispose of the headset into fire or water.

Note 7: Please bounce up the charging base switch if the headset idles for a long time to avoid power consumption.

Turning ON/OFF

Method 1

In OFF MODE, press and hold headset(R) or headset(L) MFB for 2 seconds to turn on.

In ON MODE, press and hold headset(R) or headset(L) MFB for 5 seconds to turn off.

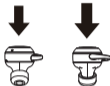

Method 2

Pick up the headsets from the charging base to turn on automatically.
Put them back to power off and charge the headset.
(Make sure the charging base switch is pressed down)



Note: Please put the headset into the charging case and take it out after 10 seconds.
In case take it out too quickly, it will not active the earphones.

TWS Pairing

Method 1

On OFF state, press MFB of headset (R) or headset (L) for 2 seconds to power on and waiting for about 10 seconds, the two headsets will enter auto-pairing mode. The two headsets connect with each other after few seconds, the headset (R) alternately flashing red and blue, and then open the phone's bluetooth device to search (VHP-TW20)



Method 2

Pick up the two headsets from the charging base to power on and waiting for 10 seconds, the two headsets will enter auto-pairing mode. The two headsets connect with each other after few seconds, the headset (R) alternately flashing red and blue, and then open the phone's bluetooth device to search. Do as the above ways: 1 or 2, after TWS successfully paired: left headset prompts "left channel" and right headset prompts "right channel-pairing"



TWS Pairing

Cell phone begins to search for bluetooth devices (see the user guide of your phone for instructions). Mobile phone to search for "VHP-TW20" and select the "VHP-TW20".



TWS Reconnected

Method 1

Press headset (R) and (L) multifunction button at the same time for 2 seconds to power on.

Wait for several seconds and the two headsets will automatically connect wait a few seconds for the headset to connect with the paired phone

Re-connection successfully.

Método 2

When you pick up the headset from the charging case after 3 seconds to power on

Wait for a few seconds, the two headsets will automatically connect

Wait for a few seconds, the headset will be linked with the paired mobile phone

Re-connection successfully.

TWS Reconnected

Note: The main headset and vice headset speakers will emit "Connected", (L) prompts "Left Channel", (R) prompts "Right Channel" at the same time, and the main headset prompts "Second Device connected" after successful connection with the mobile phone. After the headset has used the switching function, both the left and the right headset can be used as the main ear, it will not affect the use

Answering / Ending a Call

When incoming call, short press MFB of headset (R) or headset (L), the speaker prompts once "Du" to answer call

In call mode, short press MFB of headset (R) or headset (L) until heard "Call end" to end a call.



Rejecting a call



1. When incoming call, long press the MFB button of the main earphone (R) for 2 seconds, then the main earphone (R) speaker will prompt "du" + "Call Reject".
2. When incoming call, long press the MFB button of the earphone (L) for 2 seconds, then the vice earphone (L) speaker will prompt "du" + "Call Reject".

Siri or Google Assistant function

On standby mode or music playing state, short press the earphone (L), the speakers will prompt once "Voice dial" to activate this function. Note: This feature only supports mobile phones with voice dial-up functions.



Two-call Handling

(Only support the mobile phone which has the function of handling two phones.) When you are answering a call, there is another call coming :

1. Long press MFB of headset(R) or headset(L) for 2 seconds to end the current call and answer incoming call;
2. Short press MFB of headset(R) or headset(L) to hold the current call and answer incoming call;
3. After the second implementation, short press MFB of headset(R) or headset(L) to switch between two calls;
4. After the second implementation, long press MFB of headset(R) or headset(L) for 2 seconds to end the current call, and short press MFB to end the other call.

Note: All the above operations have to respect the precondition supported Bluetooth hands free profile V1.5 and Phones are running holding function (Network services) from telecom.

Music Pause/Playing

On standby mode, shortly press MFB of headset(R) to play music.

On music playing state, shortly press MFB of headset(R) to PAUSE music. But headset(L) can not pause music independently.



Adjusting the Volume

In call mode or music mode, double press MFB of the headset(R) to volume up and double press the headset(L) to volume down. Once "Du" can be heard from headset (R) when volume is up to maximum or minimum.

Forward/Backward

In music playing mode, long press MFB of headset(R) for 2 seconds till hear speaker prompt "Du+Du di" to next song; Long press the headset(L) multi-function button about 2 seconds till hear twice "Du+Du di", it will play last song.

Delete Pairing Records on the Headset

In any state, press and hold the headset multi-function button for about 10 seconds (off state) → ON MODE (2 seconds) → Delete pairing records(10 seconds), until hearing the "Du" voice for 3 times, and the red/blue light flashes twice at the same time.

Function Instruction of Charging Base

The instruction of charging base indicator light

Four blue indicator lights, each of which represents 25% of the battery.

Charging base indicator light

On charging mode of charging base, flash blue indicator light.

- One light is always on, which means charging base battery power fully charged by 25%;
- Two lights mean charging base battery power has been fully charged by 50%;
- Three lights mean charging battery power fully charged by 75%;
- Four lights mean charging base battery power fully charged by 100%.

Function Instruction of Charging Base

Charging base battery display

When no charging but opening the charging base, after four indicator flash in turn (about 1.5 seconds to complete flash), the indicator will light on for about 5 seconds to show how much battery is left (after 5 seconds, indicator lights all off).

- One light is always on, which means charging base battery power fully charged by 25%;
- Two lights mean charging base battery power fully charged by 50%;
- Three lights mean charging base battery power fully charged by 75%;
- Four lights mean charging base battery power fully charged by 100%.

The instructions of headset charging power switch

1. When switch button is pressed, headsets charging position 5V probe is normal output and headsets can be charged normally. When switch button is bounced, headsets charging position 5V probe output off, headsets can not be charged and will automatically on. Please off headsets manually at this time. After headsets are off, they can be stored in charging base, which will not consume battery power of charging base.
2. If switch button is pressed and no use for a long time, headsets will run out of charging base battery power.



Note

This equipment has been tested and found to comply with the limits for a Class B digital device, pursuant to part 15 of the FCC Rules. These limits are designed to provide reasonable protection against harmful interference in a residential installation. This equipment generates uses and can radiate radio frequency energy and, if not installed and used in accordance with the instructions, may cause harmful interference to radio communications. However, there is no guarantee that interference will not occur in a particular installation. If this equipment does cause harmful interference to radio or television reception, which can be determined by turning the equipment off and on, the user is encouraged to try to correct the interference by one or more of the following measures:

- Reorient or relocate the receiving antenna.
 - Increase the separation between the equipment and receiver.
 - Connect the equipment into an outlet on a circuit different from that to which the receiver is connected.
 - Consult the dealer or an experienced radio/TV technician for help
- Changes or modifications not expressly approved by the party responsible for compliance could void the user's authority to operate the equipment. This device complies with Part 15 of the FCC Rules. Operation is subject to the following two conditions:
- (1) this device may not cause harmful interference, and
 - (2) this device must accept any interference received, including interference that may cause undesired operation.

**VIETA
PRO**

www.vietapro.com